



23 Benbow Quay, Shrewsbury, SY1 2DL

2 bedroom first floor apartment — £180,000 Leasehold

23 Benbow Quay, Shrewsbury, SY1 2DL

Coopergreenpooks.co.uk

£180,000 Leasehold — 2 bedroom first floor apartment

sales@cgpooks.co.uk

A superb first floor apartment with a very well presented interior and balcony, from which there are lovely views across the River Severn. The property is located in a fantastic position within this attractive development, has the benefit of a private parking space and is also just a few minutes' walk from the town centre.

KEY FEATURES

- Entrance hall with built in storage and entry phone system.
- Good sized living room which has window and glazed double doors that open onto a wrought iron balcony which provides space for a small table and 2 chairs.
- Separate kitchen that has room for a dining table, further window providing river views and a range of fitted units with integrated appliances.
- Bathroom and 2 double bedrooms, one of which has a built in wardrobe.
- Electric heating and double-glazed windows.
- Well-kept communal grounds and a private parking space close to the entrance.
- Very good location, only a 5-minute walk from Shrewsbury railway station and the town centre.

Cooper Green Pooks
3 Barker Street
Shrewsbury
SY1 1QF

www.cgpooks.co.uk
sales@cgpooks.co.uk
01743 276666



Ground Floor

Approx. 61.3 sq. metres (659.5 sq. feet)

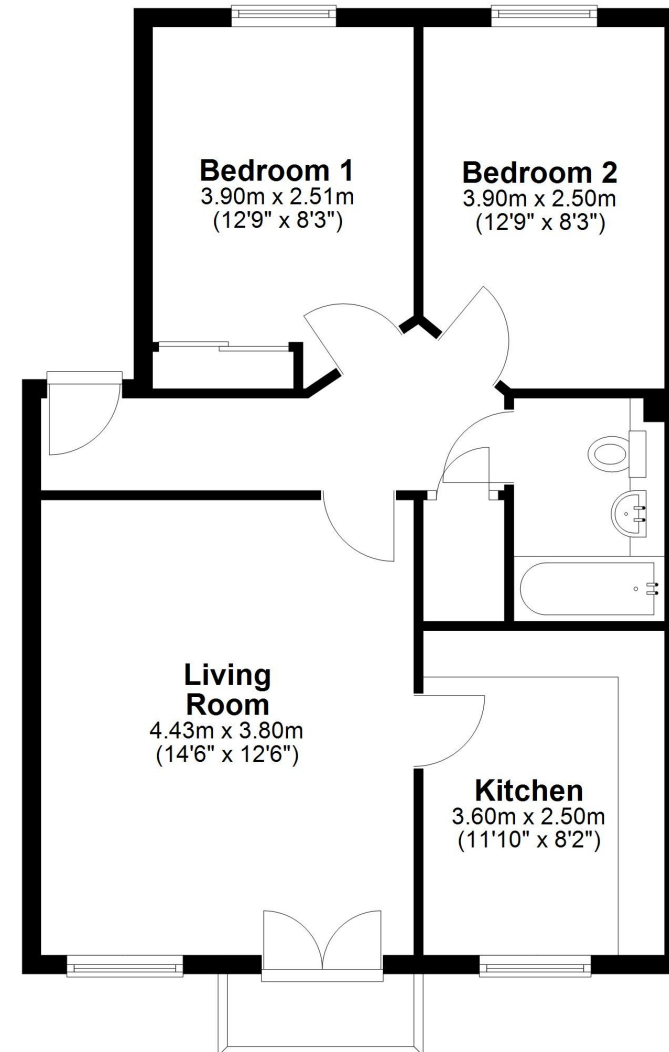

Total area: approx. 61.3 sq. metres (659.5 sq. feet)





rightmove 

 OnTheMarketTM.com

 **RICS**
Regulated by RICS

 **expert mortgage advice available**

3 Barker St, Shrewsbury SY1 1QF

Cooper Green Pooks
01743 276666



Your home may be repossessed if you do not keep up repayments on your mortgage.

There may be a fee for mortgage advice. The actual amount you pay will depend upon your circumstances. The fee is up to 1% but a typical fee is 0.3% of the amount borrowed.

23 Benbow Quay, Shrewsbury, SY1 2DL

£180,000 Leasehold — 2 bedroom first floor apartment

sales@cgpooks.co.uk



BOUNDARIES NOT CONFIRMED

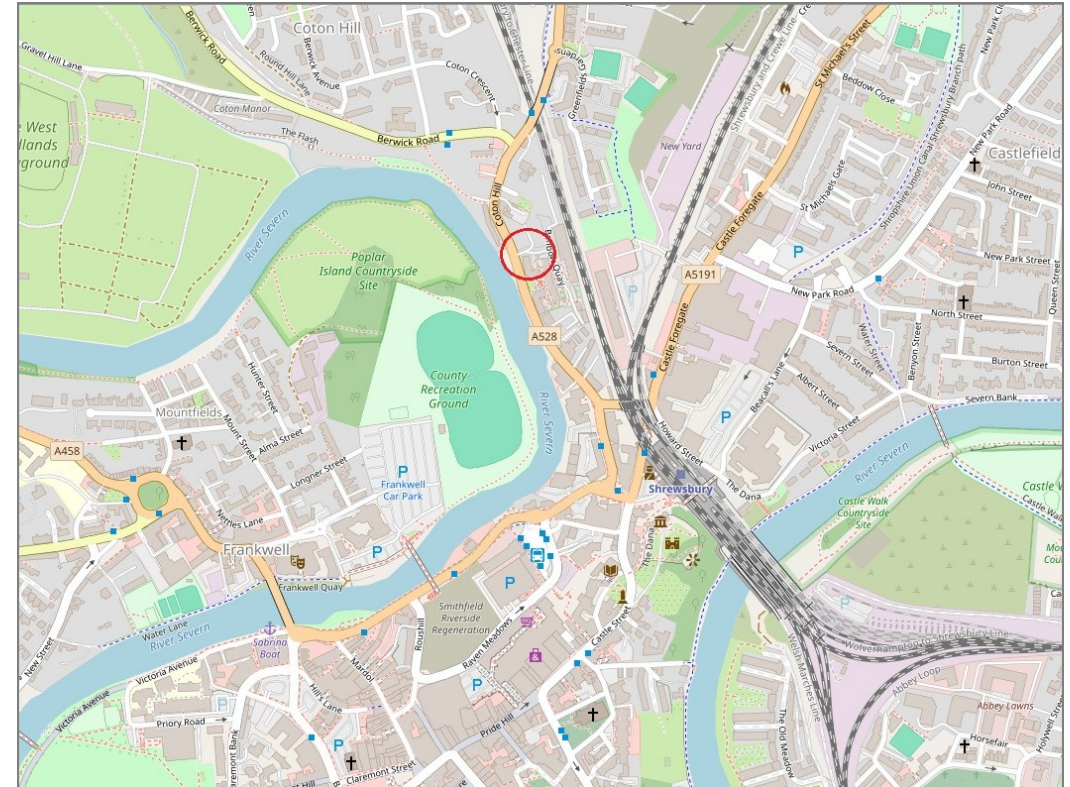

Local Authority	Shropshire Council
Council Tax	Band A
EPC Band	Band C
Services	Mains water, electricity and drainage are connected. Electric heating.

Tenure	Leasehold
Lease length	199 years from 2005
Service charge	£2,800 per annum
Ground rent	£100 per annum

23 Benbow Quay, Shrewsbury, SY1 2DL

Coopergreenpooks.co.uk

£180,000 Leasehold — 2 bedroom first floor apartment

sales@cgpooks.co.uk

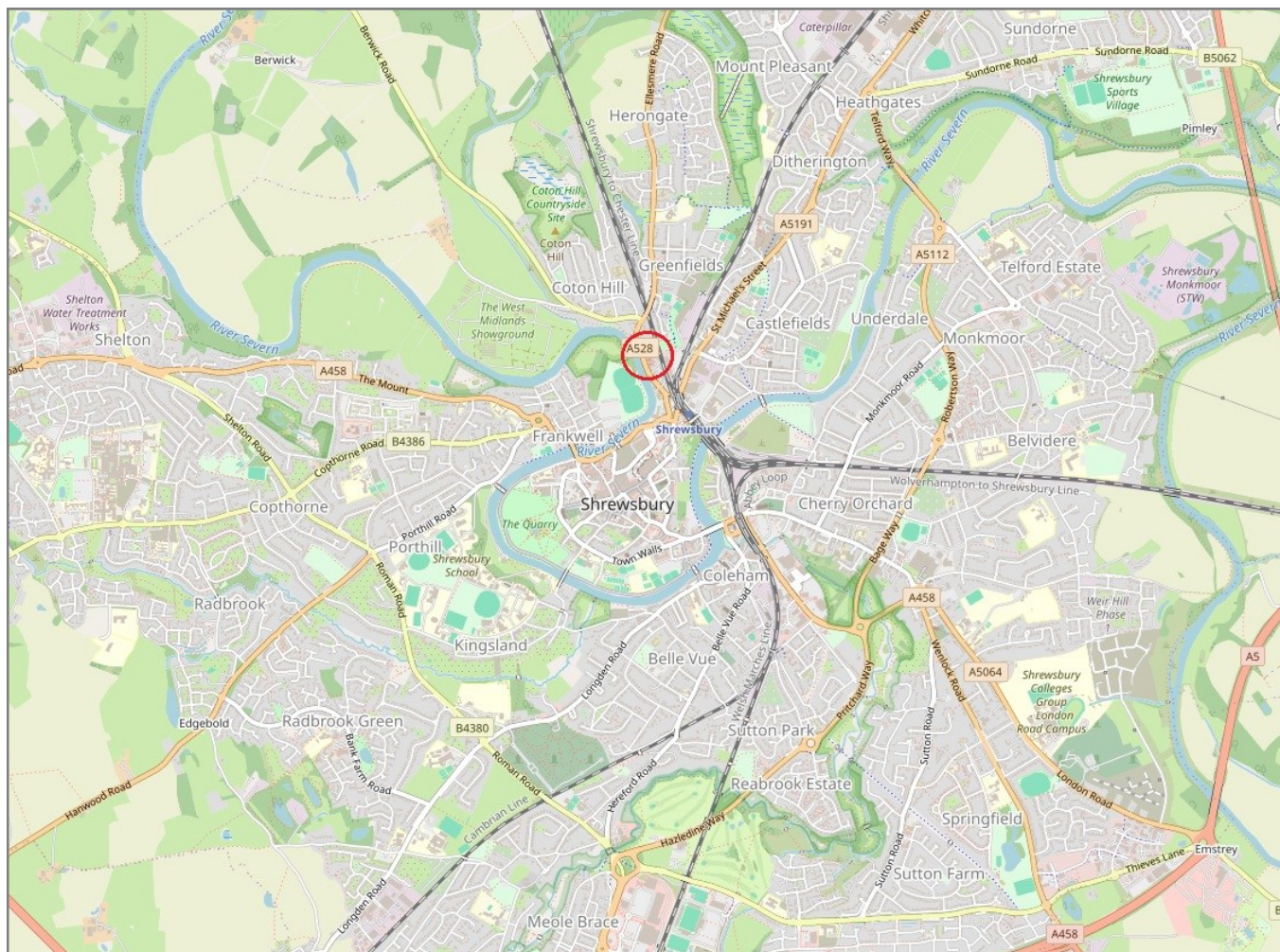

IMPORTANT NOTICE: Cooper Green Pooks for themselves and for the lessors or vendors of this property whose agents they are give notice that: 1 No appliances, services or service installations have been tested and no warranty as to suitability or serviceability is implied. Any prospective purchaser or lessee is advised to obtain verification from their surveyor or solicitor. 2. The particulars are set out as a general outline only for the guidance of the intended purchasers or lessees and do not constitute, nor constitute part of, an offer or contract. 3. All descriptions, reference to condition and necessary permissions for use and occupation and other details are given in good faith and are believed to be correct but any intending purchasers or lessees should not rely on them as statements or representation of fact but satisfy themselves by inspection or otherwise as to the correctness of each of them. 4. No person in the employment of Cooper Green Pooks has any authority to make or give any representation or warranty whatsoever in relation to this property. 5. All rentals and prices are quoted exclusive of Stamp Duty, legal and surveyors fees and any other associated purchasers or lessees costs. 6. Floor plans are indicative only and should not be relied on. 7. The plan showing the boundary of the property is indicative only and has not been checked against the legal title so should not be relied on. 8. All dimensions, floor areas and site areas are only approximate and should not be relied on. Dimensions are generally maximum room dimension.